

REMOVAL

1. w/ DIFF. LOCK:

SHIFTING DIFF. LOCK POSITION

- (a) Turn the ignition switch to the ON position.
- (b) Push the differential lock control switch to the ON position and lock the rear differential.

HINT:

Rotating the tires, check they are in the differential lock condition.

- (c) Disconnect the cable from the negative terminal of the battery.

HINT:

At the time of installation, after installation, check that the breather plug at the end of the breather tube (inside of the LH frame) is not damaged or worn.

2. DRAIN DIFFERENTIAL OIL

Torque: 49 N·m (500 kgf·cm, 36 ft·lbf)

3. REMOVE REAR AXLE SHAFTS (See page [SA-81](#))

4. REMOVE REAR PROPELLER SHAFT

(See page [PR-4](#) or [PR-8](#))

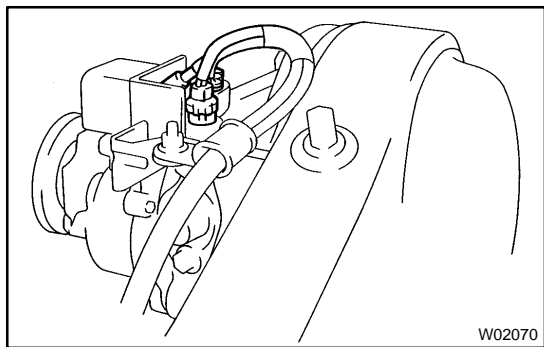

5. w/ DIFF. LOCK:

DISCONNECT CONNECTORS AND TUBE

HINT:

At the time of installation, please refer to the following items.

- When connecting the tube of the harness side to the hose of the actuator side, its depth of insertion is 15 mm (0.59 in.).
- Take care that water or equivalent dose not adhere to the connector and hose.

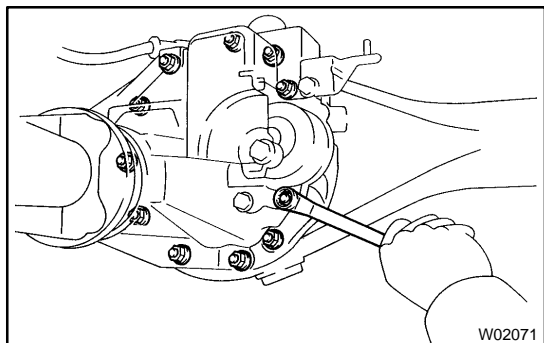

6. REMOVE DIFFERENTIAL CARRIER ASSEMBLY

- (a) Remove the 10 nuts, washers and differential carrier assembly.

NOTICE:

Be careful not to damage the installation surface.

Torque:

w/o Diff. lock: 73 N·m (740 kgf·cm, 54 ft·lbf)

w/ Diff. lock: 25 N·m (250 kgf·cm, 18 ft·lbf)

(b) Remove the gasket.

HINT:

At the time of installation, please refer to the following items.

w/ Diff. lock:

- Before installation, check differential lock operation connect the connector of the actuator to the connector of the vehicle side.
- Before installation, check that the sleeves on work with switching over the differential lock control switch.

After checking, lock the rear differential.